

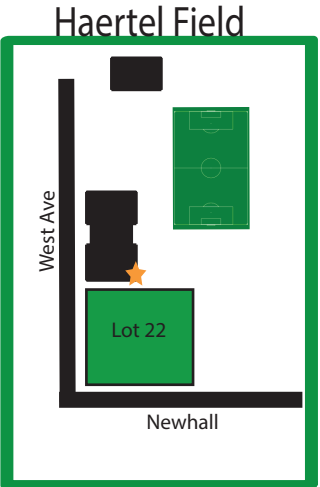

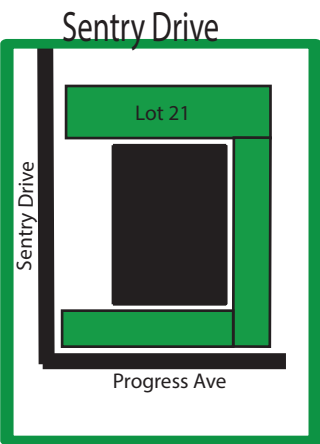

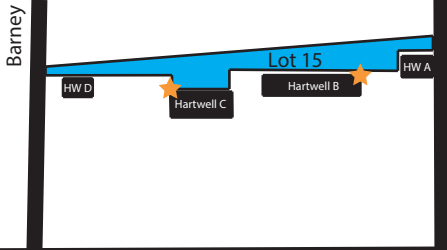

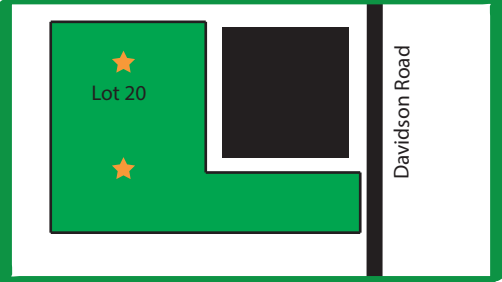
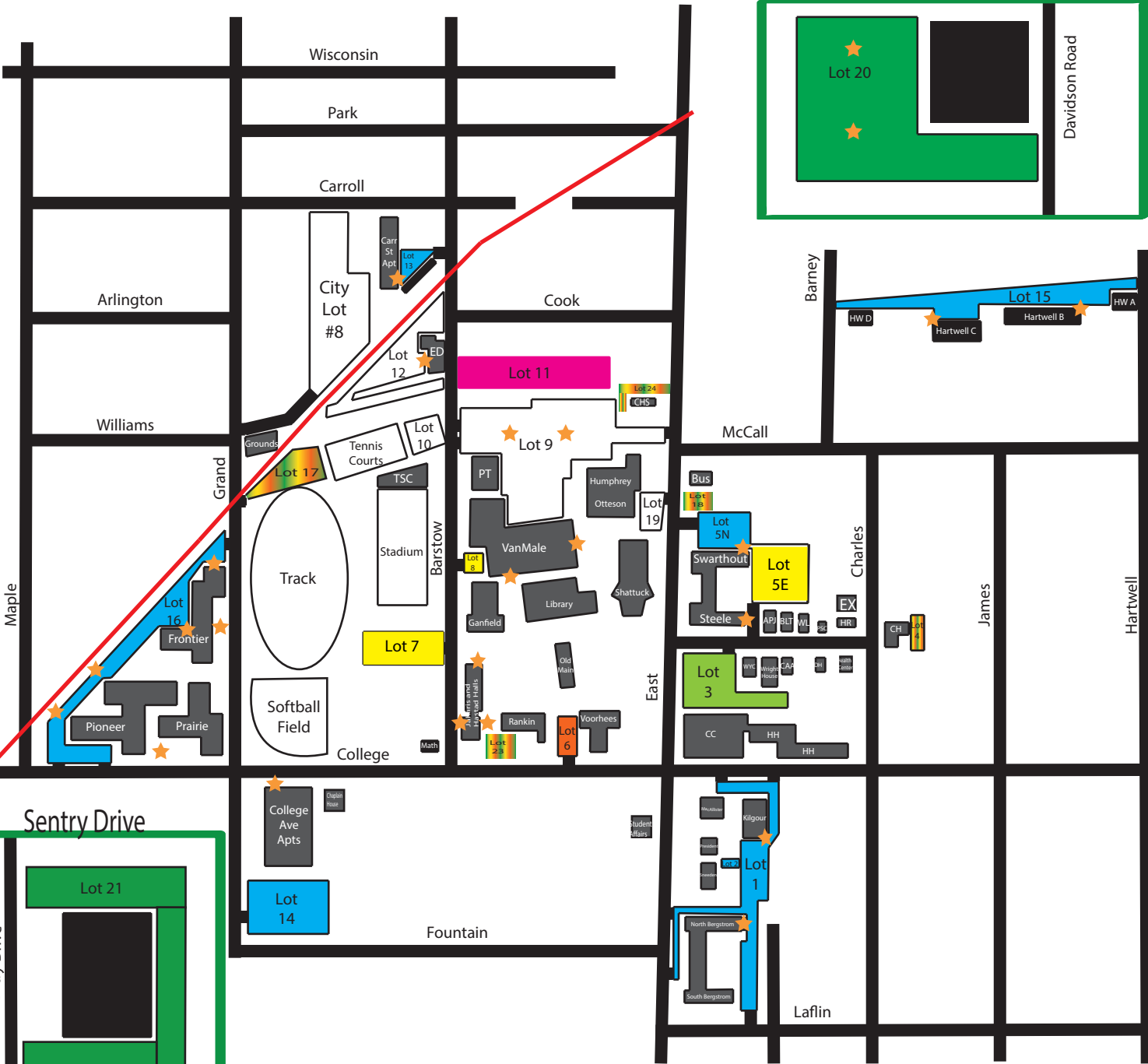

Center for Graduate Studies



-  Restricted Designated Parking Only (Lots 4,17,18, 23 and 24)
-  Commuter Permit Only, Open Parking on weekends, No Parking 2AM-6AM everyday (Lot 11)
-  Restricted to authorized permitted resident vehicles (Lots 1, 2, 5N, 13, 14, 15,16, and garages)
-  F/S & Retail Permit 6AM-4PM, open parking evenings & weekends, No parking 2AM-6AM everyday (Lots 5E,7,8)
-  Guest parking daytime & evening, No Resident or Commuter parking. No parking 2AM-6AM everyday (Lot 3)
-  Open parking daytime and evening, Overflow & Commuter permits allowed, NO resident lot permits, overnight by permit only (Lots 9, 10, and 12). No overnight parking in Lot 19.
-  Visitor parking for vehicles with a valid "Voorhees" lot pass. Open parking on weekends, no parking 2AM-6AM everyday (Lot 6)
-  Emergency Blue Light Phone